



Knurling

Knurling Holder & Wheel

A.478

USR GROUP

KNURLING

ROLL KNURLING HOLDER S1-MODEL

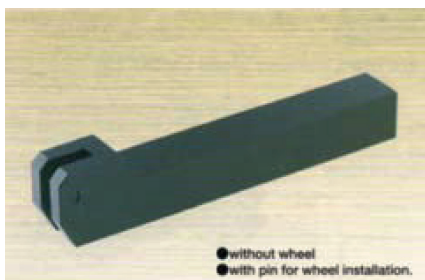

KH S1

For domestic standard knurling wheel : plain cut

■ FEATURES

Workable for domestic standard knurling wheel



(Unit : mm)

| Item No. | W | D | H | L | Knurling range | Weight (g) | Applicable knurling wheel |
|----------|-----|-----|----|-----|----------------|------------|---------------------------|
| KHS1 | 6.5 | 4.7 | 20 | 147 | φ10 ~ φ250 | 420 | KNS F 14~F50 |

ROLL AUTO-SLIDING KNURLING HOLDER



KHS

For domestic standard knurling wheel : cross cut

■ FEATURES

● Easy installation

Original positioning mechanism is provided in the supporting part of the knurling wheel. The clear original position enables a easy installation to Auto and NC lathe.

● No-need for accurate positioning

The tolerance of center is adjustable with the auto-sliding mechanism. The centering range is within +/- 2.5mm. to the center position.

● Fine Finish

Up and down movement of the knurling wheel supporting part for auto-sliding knurling holder reduces the difference of rolling power between knurling wheels and enables and even knurling processed depth.

With auto-centering mechanism

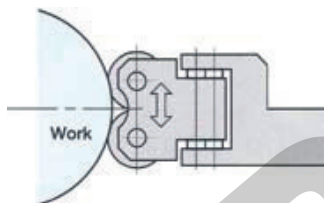

(Unit : mm)

| Item No. | W | D | H | L | Knurling range | Weight (g) | Applicable knurling wheel |
|----------|-----|-----|----|-----|----------------|------------|---------------------------|
| KHS | 6.5 | 4.7 | 20 | 147 | φ10 ~ φ250 | 550 | KNS RL 14~50 |

ROLL KNURLING WHEEL

KNS

Domestic standard knurling wheel (for holder, KH S and KH S1)



RL (Cross cut)



(material SKS-31)

F (Plain cut)

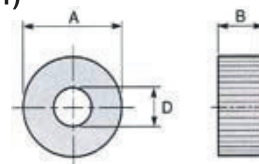

(Unit : mm)

| Item No. | | Knurls | No. of knurl per inch. | Pitch | Module | External dia. A | Width B | Hole dia. D |
|--------------------|-----------|--------|------------------------|-------|--------|-----------------|---------|-------------|
| Cross cut (a pair) | Plain cut | | | | | | | |
| KNS RL14 | KNS F14 | Course | 14 | 1.81 | 0.58 | 19.2 | 6.35 | 4.76 |
| KNS RL16 | KNS F16 | | 16 | 1.59 | 0.51 | | | |
| KNS RL18 | KNS F18 | | 18 | 1.41 | 0.45 | | | |
| KNS RL20 | KNS F20 | | 20 | 1.27 | 0.40 | | | |
| KNS RL22 | KNS F22 | Medium | 22 | 1.15 | 0.37 | | | |
| KNS RL24 | KNS F24 | | 24 | 1.06 | 0.34 | | | |
| KNS RL26 | KNS F26 | | 26 | 1.00 | 0.32 | | | |
| KNS RL28 | KNS F28 | | 28 | 0.92 | 0.30 | | | |
| KNS RL30 | KNS F30 | Fine | 30 | 0.85 | 0.27 | | | |
| KNS RL32 | KNS F32 | | 32 | 0.79 | 0.25 | | | |
| KNS RL34 | KNS F34 | | 34 | 0.75 | 0.24 | | | |
| KNS RL40 | KNS F40 | | 40 | 0.64 | 0.20 | | | |
| KNS RL50 | KNS F50 | 50 | 0.51 | 0.16 | | | | |