



BT Series  
รุ่น BT [BT30, 40, 50]

BT Series  
รุ่น BT

HKS Series  
รุ่น HSK

ST Series  
รุ่น ST

Versatile Tool

Cutting Tool

Accessories

Drill Chuck

Milling Chuck

Hard Chuck

Collet Chuck

Drill Chuck

Hy-Dual Chuck

Tap Chuck

Boring Chuck

Side Lock Chuck

Morse Taper  
Holder

Face Mill Arbor

Shell Mill Arbor

Side Cutter Arbor

Traction Drive Speed  
Accelerator

Oil-Hole Adapter

Angle Head Holder



- Thru-the-tool Coolant Available
- Thru-the-groove Coolant Available
- BBT Available

(sold separately)

- Collet → Page 930
- Screw → Page 932
- Wrench → Page 934

### Standard

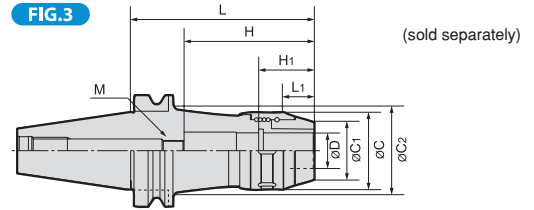
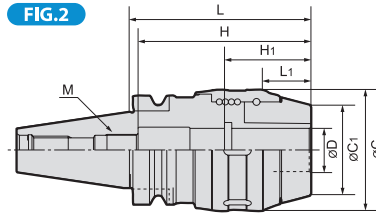
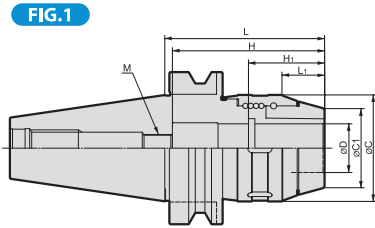

Cutter shank diameter should be h7 or better

Order No.	Class A	Class AA	BBT	Fig	ØD	L	L1	ØC	ØC1	H	H1	最小刃具挿入量		調整量	M	N/W (kg)		
												スキマスルー	センタースルー					
Max. 10,000 min <sup>-1</sup>																		
BT30 (BBT30)	HPC16-	100	○	○	○	16	100	26	56	34	85	50	40	51	70 ~ 80	M10	1.4	
	HPC20-	100	○	○	○												38	45
	HPC25-	100	△	△	△	25	105	27.5	62	44	80	53	50	55	57 ~ 70	M18	1.6	
	HPC32-	105	△	△	△												70	52
Max. 10,000 min <sup>-1</sup>																		
BT40 (BBT40)	HPC16-	090	○	○	○	16	90	26	56	34	85	50	40	51	70 ~ 80	M10	1.8	
		120	△	△	△												120	38
		HPC20-	090	○	○	○	20	120	27.5	62	44	100	53	50	55	77 ~ 90	M18	1.7
			120	△	△	△												120
	HPC25-	105	○	○	○	25	105	105	62	44	100	53	55	55	77 ~ 90	M18	2	
		135	△	△	△												135	52
	HPC32-	105	○	○	○	32	105	30.5	82	62	100	57	60	60	77 ~ 90	M18	2.2	
		135	△	△	△												135	52
	HPC42-	135	△	△	△	42	135	30.5	82	62	100	57	60	60	77 ~ 90	M18	3.5	

Order No.	Class A	Class AA	BBT	Fig	ØD	L	L1	ØC	ØC1	ØC2	H	H1	最小刃具挿入量		調整量	M	N/W (kg)	
													スキマスルー	センタースルー				
Max. 8,000 min <sup>-1</sup>																		
BT50 (BBT50)	HPC16-	105	○	○	○	16	105	26	56	34	85	50	40	51	70 ~ 80	M10	4.4	
		135	△	△	△												135	57
		HPC20-	105	○	○	○	20	105	27.5	62	44	100	53	50	55	77 ~ 90	M18	5.5
			165	△	△	△												165
	HPC25-	105	○	○	○	25	105	105	62	44	100	53	55	55	77 ~ 90	M18	4.3	
		135	△	△	△												135	57
	HPC32-	105	○	○	○	32	105	27.5	70	52	117	53	55	55	94 ~ 107	M18	4.4	
		135	△	△	△												135	70
	HPC25-	165	○	○	△	25	165	105	62	44	100	53	55	55	77 ~ 90	M18	5.7	
		200	△	△	△												200	72
		250	△注4	-	△	3	250	105	62	44	100	53	55	55	94 ~ 107	M18	7.8	
		300	△注4	-	△												300	-
HPC32-		105	○	○	○	32	105	27.5	70	52	117	53	55	55	94 ~ 107	M18	4.4	
		135	△	△	△												135	70
HPC32-	165	○	○	△	32	165	105	70	52	117	53	55	55	94 ~ 107	M18	5.6		
	200	△	△	△												200	75	55
HPC32-	250	△注4	-	△	3	250	105	70	52	117	53	55	55	94 ~ 107	M18	8.6		
	300	△注4	-	△												300	-	55

Order No.	Class A	Class AA	BBT	Fig	ØD	L	L1	ØC	ØC1	ØC2	H	H1	最小刃具挿入量		調整量	M	N/W (kg)	
													スキマスルー	センタースルー				
<b>BT50 (BBT50)</b>	<b>HPC42-</b>	<b>110</b>	○	○	○	42	110	30.5	82	62	80	122	57	60	60	99 ~ 112	M18	4.6
		<b>135</b>	△	△	△		135											5.3
		<b>165</b>	○	○	△		165											6.2
		<b>200</b>	△	△	-		200											8.3

△: Mark tools are manufactured to order.

NOTE :

1. Chuck wrench and adjust screw are sold separately.
2. Insert the O-ring included in the box to the groove of the ID for thru-the-tool use.
3. The above-mentioned maximum speed will vary depending rigidity of the machine and balance of cutter. An adequate cutting condition should be selected for each case.

### ORDERING EXAMPLE

①	②	③	④	⑤
<b>BT30</b>	<b>- HPC</b>	<b>16</b>	<b>- 100</b>	<b>A</b>
① Shank Size				
② Holder's Name				
③ Cutter's Shank Dia.				
④ G.L. Length				
⑤ Grade				

### BT Series

รุ่น BT

### HKS Series

รุ่น HSK

### ST Series

รุ่น ST

### Versatile Tool

### Cutting Tool

### Accessories

### Drill Chuck

### Milling Chuck

Hard Chuck

Collet Chuck

Drill Chuck

Hy-Dual Chuck

Tap Chuck

Boring Chuck

Side Lock Chuck

Morse Taper

Holder

Face Mill Arbor

Shell Mill Arbor

Side Cutter Arbor

Traction Drive Speed Accelerator

Oil-Hole Adapter

Angle Head Holder

## หัวจับ

## MICRON CHUCK H Series



## H-series

FIG.1

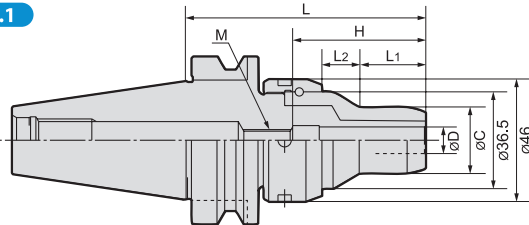
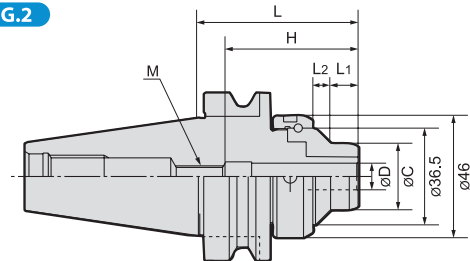

FIG.2



Cutter shank diameter should be h7 or better

Order No.	Class A	Class AA	G Type	Fig	ØD	L	L1	L2	ØC	H	最小刃具挿入量	調整量		調整ネジ M	スキマスルー	センタースルー	N/W (kg)					
												MIN	MAX									
Max. 20,000 min <sup>-1</sup> (G Type : Max. 30,000 min <sup>-1</sup> )																						
<b>BT30 (BBT30)</b>	<b>HPC03H</b>	<b>060</b>	○	○	○	2	3	60	10.3	6.7	25	15	-	-	-	○	○追加加工	0.9				
		<b>090</b>	○	○	○	1	90	25	14	○						○追加加工	1					
	<b>HPC04H</b>	<b>060</b>	○	○	○	2	4	60	10.3	6.7						37.5	37	AS17-2-M5-CTW	×	○	0.9	
		<b>090</b>	○	○	○	1	90	25	14	○有償									○	1		
	<b>HPC05H</b>	<b>060</b>	△	△	△	2	5	60	10.3	6.7						50	35	AS22-2-M6-CTW	×	○	0.9	
		<b>090</b>	△	△	△	1	90	25	14	○有償									○	1		
	<b>HPC06H</b>	<b>060</b>	○	○	○	2	6	60	10.3	6.7						32	50	AS22-2-M8-CTW	×	○	0.9	
		<b>090</b>	○	○	○	1	90	25	14	○有償									○	1		
	<b>HPC07H</b>	<b>060</b>	△	△	△	2	7	60	10.3	6.7						32	55	AS25-2-M10-CTW	×	○	0.9	
		<b>090</b>	△	△	△	1	90	25	14	○有償									○	1		
	<b>HPC08H</b>	<b>060</b>	○	○	○	2	8	60	10.3	6.7						60	40	42	60	×	○	0.9
		<b>090</b>	○	○	○	1	90	25	14	○有償										○	1	
	<b>HPC09H</b>	<b>060</b>	△	△	△	2	9	60	10.3	6.7						60	40	42	60	×	○	0.9
		<b>090</b>	△	△	△	1	90	25	14	○有償										○	1	
	<b>HPC10H</b>	<b>060</b>	○	○	○	2	10	60	10.3	6.7						60	40	42	60	×	○	0.9
		<b>090</b>	○	○	○	1	90	25	14	○有償										○	1	
	<b>HPC11H</b>	<b>060</b>	△	△	△	2	11	60	12.2	4.8						60	40	42	60	×	○	0.9
		<b>090</b>	△	△	△	1	90	25	14	○有償										○	1	
<b>HPC12H</b>	<b>060</b>	○	○	○	2	12	60	12.2	4.8	60	40	42	60	×	○	0.9						
	<b>090</b>	○	○	○	1	90	25	14	○有償					○	1							
<b>HPC13H</b>	<b>090</b>	△	△	△	1	13	90	25	14	32	60	40	42	60	×	○	1					