

หัวจับดอกสว่าน

DRILL CHUCK - TAPER MOUNTED MODEL

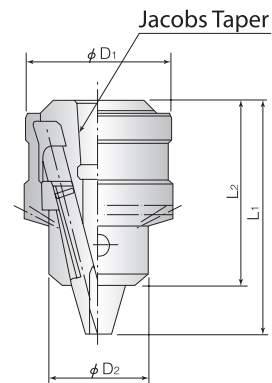

Order No.	Capacity	Jacobs Taper	D1	D2	L1	L2	Weight (kg)
3MG	0.3 ~ 3	JT.NO.0	21	15	34.5	28	45
4MG	0.3 ~ 4	JT.NO.0	21	15	34.5	28	45
D5MG	0.5 ~ 5	JT.NO.D	27	18	41	32	80
5MG	0.5 ~ 5	JT.NO.1	32	22	49.5	40	145
6.5ELMG	0.5 ~ 6.5	JT.NO.1	32	22	49.5	40	145
6.5MG	0.5 ~ 6.5	JT.NO.1	37	26	54.5	43	220
J8MG	0.8 ~ 8	JT.NO.1	37	26	56.5	45	220
M8MG	0.8 ~ 8	MT.NO.1S	37	26	56.5	45	220
10ELMG	0.8 ~ 10	JT.NO.2S	37	26	61	51	225
10MG	0.8 ~ 10	JT.NO.2S	45	31	69	55	390
13ELMG	1.2 ~ 13	JT.NO.6	45	33	77.5	64	415
13MG	1.2 ~ 13	JT.NO.6	52.5	38	87	68	685
14MG	1.2 ~ 14	JT.NO.3	60	44	96	73	980
16MG	3.0 ~ 16	JT.NO.3	60	44	96	73	980
19MG	3.0 ~ 19	JT.NO.4	72.5	54	124.5	95	1,840

BT Series

รุ่น BT

HKS Series

รุ่น HSK

ST Series

รุ่น ST

Versatile Tool

Cutting Tool

Accessories

Drill Chuck

Super Keyless

Dream Chuck

CNC Keyless

Drill Chuck

Keyless Drill

Chuck

Drill Chuck

Chuck Keys

หัวจับดอกสว่าน

DRILL CHUCK - THREAD MOUNTED MODEL

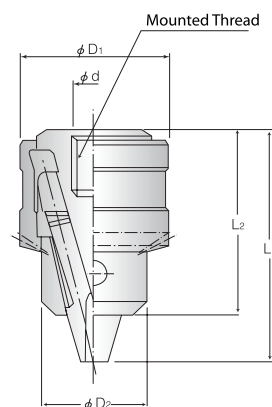

Order No.	Capacity	Jacobs Taper	D1	D2	L1	L2	d	Weight (kg)
6.5EL	0.5 ~ 6.5	3/8 - 24	32	22	49.5	40	9.67	145
8L	0.8 ~ 8	3/8 - 24	32	22	51.5	43	9.67	155
6.5	0.5 ~ 6.5	3/8 - 24	37	26	54.5	43	9.67	220
10EL	0.8 ~ 10	3/8 - 24	37	26	61	51	9.67	220
10EL	0.8 ~ 10	1/2 - 20	37	26	61	51	12.85	225
MS13EL	2.0 ~ 13	1/2 - 20	42.8	32	73	60	12.85	370
13EL	1.2 ~ 13	1/2 - 20	45	33	77.5	64	12.85	445
16LL	4.5 ~ 16	1/2 - 20	45	33	75.5	62.5	12.85	425
16EL	3.0 ~ 16	1/2 - 20	52.5	38	88	71	12.85	705