

DRILLS

ดอกสว่าน

Stright Shank

ดอกสว่านแกนตรง



ดอกสว่าน Step Borer STBH-ATH

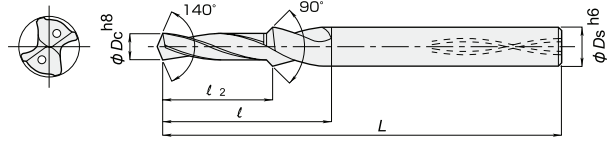
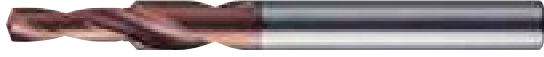

Carbide Drills
ดอกสว่านคาร์ไบด์

HSS Drills
ดอกสว่านไฮสปีด

Stub / Standard
ตัวสั้น / มาตรฐาน

Long
ตัวยาว

Micro Drill
ดอกสว่านไมโคร

Z Plunging

Step Borer

Internal coolant type (with oil holes)



Ø3.4 ~ Ø5.1 : 0 ~ -0.018
Ø6.8 ~ Ø8.5 : 0 ~ -0.022
Ø10.3 : 0 ~ -0.027



Ds=6 : 0 ~ -0.008
6 < Ds ≤ 10 : 0 ~ -0.009
10 < Ds : 0 ~ -0.011

(mm)

| Order Code | Stock | Size (mm) | | | | | | Corresponding tap size |
|--------------|-------|-----------|---------------|----------------------------|----------------|------------------|----------------------------|------------------------|
| | | D/L | Dc Small Dia. | l ₂ Step length | l Flute length | L Overall Length | Ds Shank dia. (large dia.) | |
| STBH034S-ATH | ● | 2 | 3.4 | 8 | 25 | 80 | 6.0 | M4 |
| STBH034M-ATH | ● | 3 | | 12 | 30 | 80 | 6.0 | |
| STBH043S-ATH | ● | 2 | 4.3 | 10 | 30 | 85 | 7.0 | M5 |
| STBH043M-ATH | ● | 3 | | 15 | 35 | 85 | 7.0 | |
| STBH051S-ATH | ● | 2 | 5.1 | 12 | 35 | 90 | 8.0 | M6 |
| STBH051M-ATH | ● | 3 | | 18 | 40 | 90 | 8.0 | |
| STBH068S-ATH | ● | 2 | 6.8 | 16 | 45 | 100 | 10.0 | M8 |
| STBH068M-ATH | ● | 3 | | 24 | 50 | 105 | 10.0 | |
| STBH085S-ATH | ● | 2 | 8.5 | 20 | 50 | 115 | 12.0 | M10 |
| STBH085M-ATH | ● | 3 | | 30 | 60 | 125 | 12.0 | |
| STBH103S-ATH | ● | 2 | 10.3 | 24 | 60 | 125 | 14.0 | M12 |
| STBH103M-ATH | ● | 3 | | 36 | 70 | 135 | 14.0 | |

ดอกสว่าน Step Borer STB-ATH

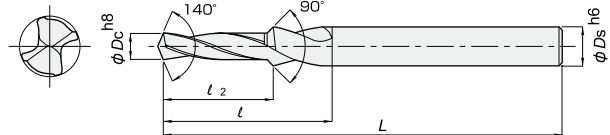
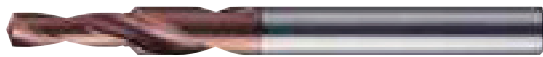

Internal coolant type (with oil holes)



Ø3.4 ~ Ø5.1 : 0 ~ -0.018
Ø6.8 ~ Ø8.5 : 0 ~ -0.022
Ø10.3 : 0 ~ -0.027



Ds=6 : 0 ~ -0.008
6 < Ds ≤ 10 : 0 ~ -0.009
10 < Ds : 0 ~ -0.011

(mm)

| Order Code | Stock | Size (mm) | | | | | | Corresponding tap size |
|-------------|-------|-----------|---------------|----------------------------|----------------|------------------|----------------------------|------------------------|
| | | L/D | Dc Small Dia. | l ₂ Step length | l Flute length | L Overall Length | Ds Shank dia. (large dia.) | |
| STB034S-ATH | ● | 2 | 3.4 | 8 | 25 | 80 | 6.0 | M4 |
| STB034M-ATH | ● | 3 | | 12 | 30 | 80 | 6.0 | |
| STB043S-ATH | ● | 2 | 4.3 | 10 | 30 | 85 | 7.0 | M5 |
| STB043M-ATH | ● | 3 | | 15 | 35 | 85 | 7.0 | |
| STB051S-ATH | ● | 2 | 5.1 | 12 | 35 | 90 | 8.0 | M6 |
| STB051M-ATH | ● | 3 | | 18 | 40 | 90 | 8.0 | |
| STB068S-ATH | ● | 2 | 6.8 | 16 | 45 | 100 | 10.0 | M8 |
| STB068M-ATH | ● | 3 | | 24 | 50 | 105 | 10.0 | |
| STB085S-ATH | ● | 2 | 8.5 | 20 | 50 | 115 | 12.0 | M10 |
| STB085M-ATH | ● | 3 | | 30 | 60 | 125 | 12.0 | |
| STB103S-ATH | ● | 2 | 10.3 | 24 | 60 | 125 | 14.0 | M12 |
| STB103M-ATH | ● | 3 | | 36 | 70 | 135 | 14.0 | |

● : Stoked Items.

- Chamfer width: for corresponding screw sizes of M4 to M6, processing to C1.0 is possible; for M8 to M12, processing to C1.5 is possible.
- Corresponding screw sizes are for metric coarse threads.

Special sizes can also be served. For details, please contact our sales office.