

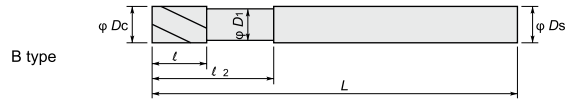

ดอกเอ็นมิลล์

**EPOCH SUS MULTI
EPSM4 -PN**

4Flutes

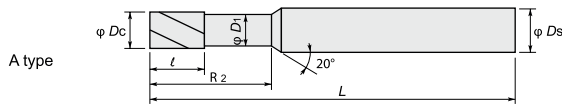

Under neck 3 Dc



$\phi 1 \sim \phi 6$: 0 ~ -0.015
 $\phi 6.5 \sim \phi 20$: 0 ~ -0.02



06~12 016~20

Ds ≤ 6 : 0 ~ -0.005
6 < Ds ≤ 10 : 0 ~ -0.006
10 < Ds ≤ 12 : 0 ~ -0.008
Ds = 16 : 0 ~ -0.011
Ds = 20 : 0 ~ -0.013

(mm)

Multi-purpose for roughing to finishing of stainless steel

Item Code	Stock	Size (mm)						No. of flutes	Type
		Dc Tool Dia.	ℓ Flute Length	ℓ ₂ Under Neck Length	D1 Neck Dia.	L Overall Length	Ds Shank Dia.		
EPSM4010-3-PN	●	1	1.5	3	0.96	56	6	4	A
EPSM4015-4.5-PN	□	1.5	2.3	4.5	1.44	56	6	4	A
EPSM4020-6-PN	●	2	3	6	1.92	56	6	4	A
EPSM4025-7.5-PN	□	2.5	3.8	7.5	2.4	56	6	4	A
EPSM4030-9-PN	●	3	4.5	9	2.88	56	6	4	A
EPSM4035-10.5-PN	□	3.5	5.3	10.5	3.35	56	6	4	A
EPSM4040-12-PN	●	4	6	12	3.7	56	6	4	A
EPSM4045-13.5-PN	□	4.5	6.8	13.5	4.15	56	6	4	A
EPSM4050-15-PN	●	5	7.5	15	4.6	56	6	4	A
EPSM4055-16.5-PN	□	5.5	8.3	16.5	5.05	56	6	4	A
EPSM4060-18-PN	●	6	9	18	5.5	56	6	4	B
EPSM4065-19.5-PN	□	6.5	9.8	19.5	5.95	63	8	4	A
EPSM4070-21-PN	●	7	10.5	21	6.4	63	8	4	A
EPSM4075-22.5-PN	□	7.5	11.3	22.5	6.85	63	8	4	A
EPSM4080-24-PN	●	8	12	24	7.3	63	8	4	B
EPSM4085-25.5-PN	□	8.5	12.8	25.5	7.8	74	10	4	A
EPSM4090-27-PN	●	9	13.5	27	8.3	74	10	4	A
EPSM4095-28.5-PN	□	9.5	14.3	28.5	8.7	74	10	4	A
EPSM4100-30-PN	●	10	15	30	9.1	74	10	4	B
EPSM4105-31.5-PN	□	10.5	15.8	31.5	9.65	86	12	4	A
EPSM4110-33-PN	●	11	16.5	33	10.2	86	12	4	A
EPSM4115-34.5-PN	□	11.5	17.3	34.5	10.6	86	12	4	A
EPSM4120-36-PN	●	12	18	36	11	86	12	4	B
EPSM4130-39-PN	□	13	19.5	39	11.7	105	16	4	A
EPSM4140-42-PN	□	14	21	42	12.7	105	16	4	A
EPSM4150-45-PN	□	15	22.5	45	13.6	110	16	4	A
EPSM4160-48-PN	●	16	24	48	14.5	110	16	4	B
EPSM4170-51-PN	□	17	25.5	51	15.4	120	20	4	A
EPSM4180-54-PN	□	18	27	54	16.3	120	20	4	A
EPSM4190-57-PN	□	19	28.5	57	17.3	125	20	4	A
EPSM4200-60-PN	●	20	30	60	18.2	125	20	4	B

□ : Stocked by specified distributor. Contact with our sales department.

● : Stocked item

Please refer to page 648-650 for Condition